

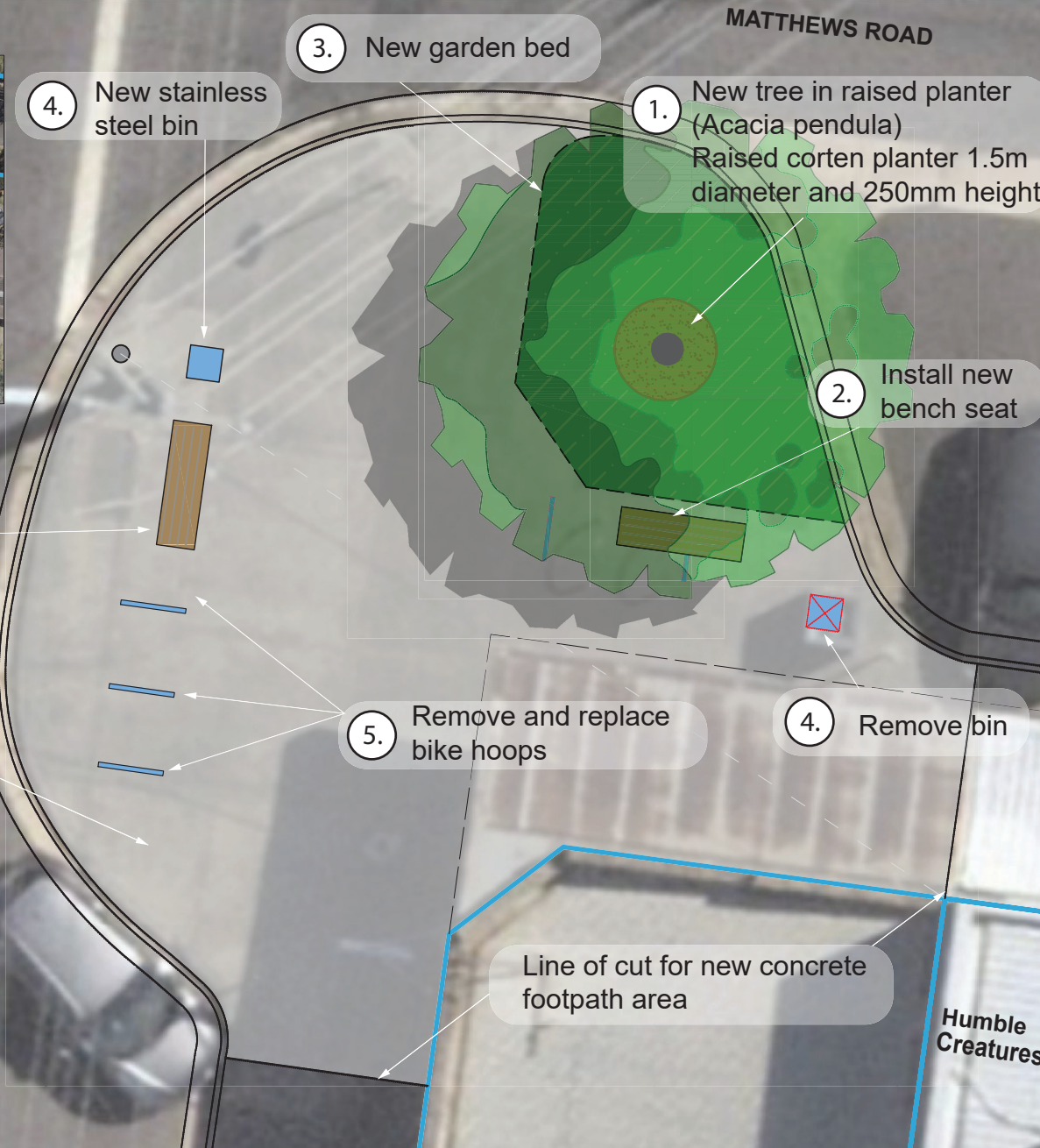

Enlarged area / focus of works



NOTE: Concept design only -
subject to change and approval

Bignell Rd and Matthews Rd

Bentleigh East - Proposed Works



Concept Plan
Scale 1:200 @ A4

Scope:

- Remove part of concrete footpath at corner of Bignell & Matthews Road
- Establish new garden beds in areas of removed footpath
- Install two (2) x new trees (Acacia pendula - Weeping Myall). Second tree along Bignell Road is subject to approval from Melbourne Water/Multinet Gas
- Provide two (2) new bench seats (second bench seat is subject to cost)
- Council Depot to pressure wash concrete footpath
- Remove and replace one (1) new stainless steel bin
- Install 3 x stainless steel bike hoops



①. Acacia pendula
"Weeping Myall" &
raised planter



②. New bench seats



③. New garden bed within
footpath



④. Remove and replace
stainless steel bin



⑤. Remove and replace
bike hoops

Rev D - 6 Nov 2024