

Our ref: 23205E

Date: 12th November 2019

Attention: Ms Adrienne Hearn
Senior Development Manager
Reshape Development
Suite 103 470 St. Kilda Rd
MELBOURNE VIC 3004

Dear Adrienne

re: **CAULFIELD VILLAGE PRECINCT 2 NORTH – SCHEMATIC DRAINAGE PLAN**

Reeds Consulting Pty Ltd has been engaged by BPG Caulfield Village Pty Ltd as the civil infrastructure engineer for the Caulfield Village Precinct 2 North project, part of the overall development project known as Caulfield Village.

As part of the development plan application providing 'whole of land' proposals, which were endorsed for progression, we provide herewith our updated Civil Site Works Schematic Drainage Plan ref: 23205E SK1 C to replace the now superseded Civil Siteworks 'Schematic Drainage Plan' ref: CG150215-CI-SK04 B that formed part of Appendix B of the Cardno 'Infrastructure Services Report - Caulfield Village – Whole of Land' dated 12/11/15.

We confirm that this Appendix has been updated for the current application but confirm that the modifications are not material to the report.

Should you have any queries regarding the above matter please do not hesitate to contact the undersigned.

Yours faithfully,
for REEDS CONSULTING PTY LTD



Sam Ravida
Joint Managing Director

enc

| LEGEND | |
|---|------------------------------|
|  | EXISTING STORMWATER DRAINAGE |

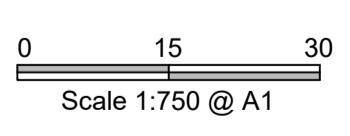
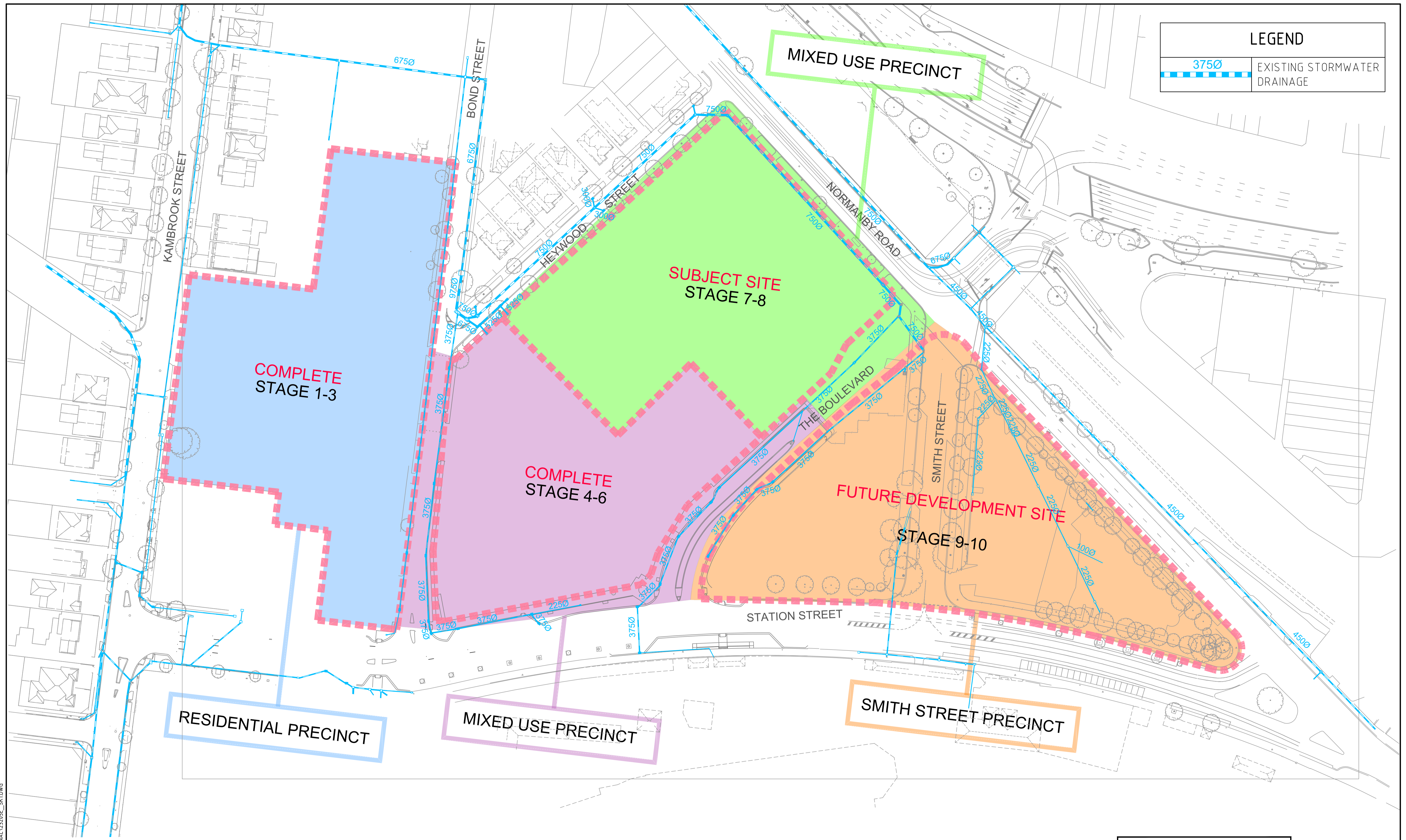

WARNING
BEWARE OF UNDERGROUND SERVICES
THE LOCATIONS OF UNDERGROUND SERVICES ARE APPROXIMATE ONLY AND THEIR EXACT POSITION SHOULD BE PROVEN ON SITE PRIOR TO COMMENCEMENT OF WORK. NO GUARANTEE IS GIVEN THAT ALL EXISTING SERVICES ARE SHOWN.

PRELIMINARY PLAN ONLY
NOT APPROVED FOR CONSTRUCTION

THIS DRAWING IS NOT TO BE COPIED OR SCALED

| VERSION | REMARKS | DATE | BY |
|---------|---|----------|----|
| C | AMENDED EXISTING DRAINAGE | 12.11.19 | PB |
| B | MIXED USE PRECINCT LABEL ADDED FOR SUBJECT SITE | 12.11.19 | PB |
| A | PRELIMINARY ISSUE | 11.11.19 | PB |

| | | | |
|----------|-------------|---------------|-----------|
| DRAWN BY | P.BRACOLIUS | DESIGNED BY | -- |
| MELWAY | 68, E1 | CHECKED BY | -- |
| DATUM | AHD | AUTHORISED BY | S. RAVIDA |

REEDS CONSULTING

LAND SURVEYING
CIVIL ENGINEERING
PLANNING
DEVELOPMENT CONSULTING

www.reedsconsulting.com.au
engineering@reedsconsulting.com.au

Lvl 6, 440 Elizabeth Street Melbourne Victoria 3000
p (03) 8660 3000

CITY OF GLEN EIRA
CAULFIELD VILLAGE - PRECINCT 2
CIVIL SITE WORKS
SCHEMATIC DRAINAGE PLAN

| | | | |
|-------------|--------|---------|---|
| DRAWING No. | SK1 | VERSION | C |
| REFERENCE | 23205E | | |
| SHEET | 1 OF 1 | | |

H:\23205\PRECINCT 2 NORTH\CAULFIELD VILLAGE SET\FUNCTIONAL\23205E_SK1.DWG