

DOWELLED CONTRACTION JOINT

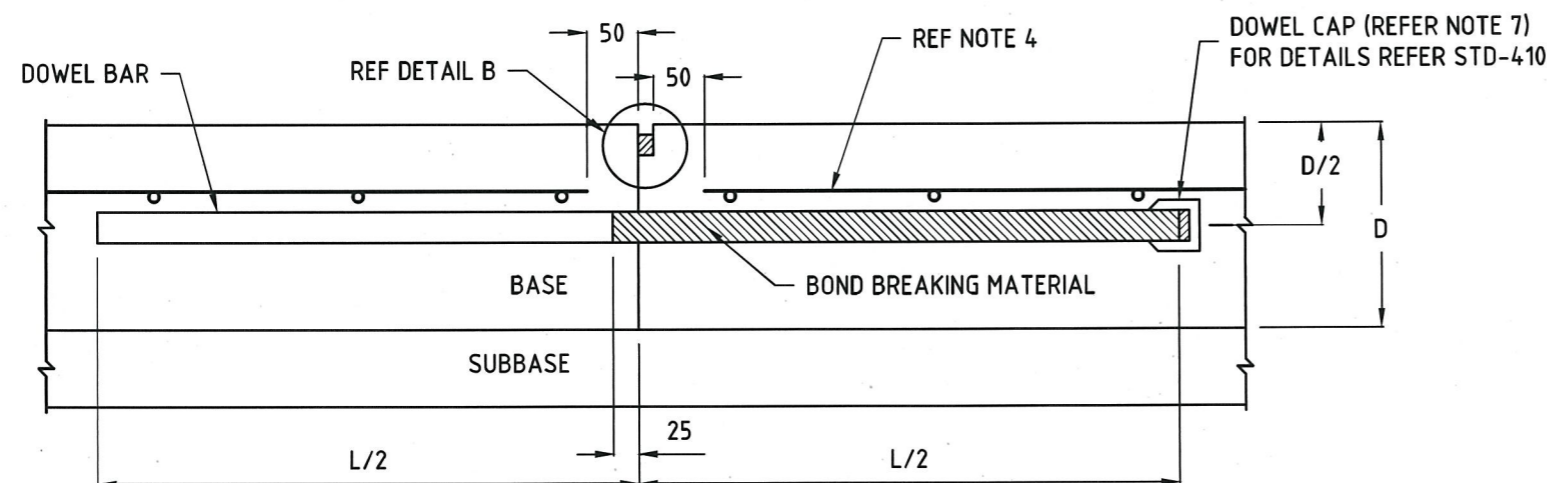

DOWELLED CONSTRUCTION JOINT - AT A CONTRACTION JOINT

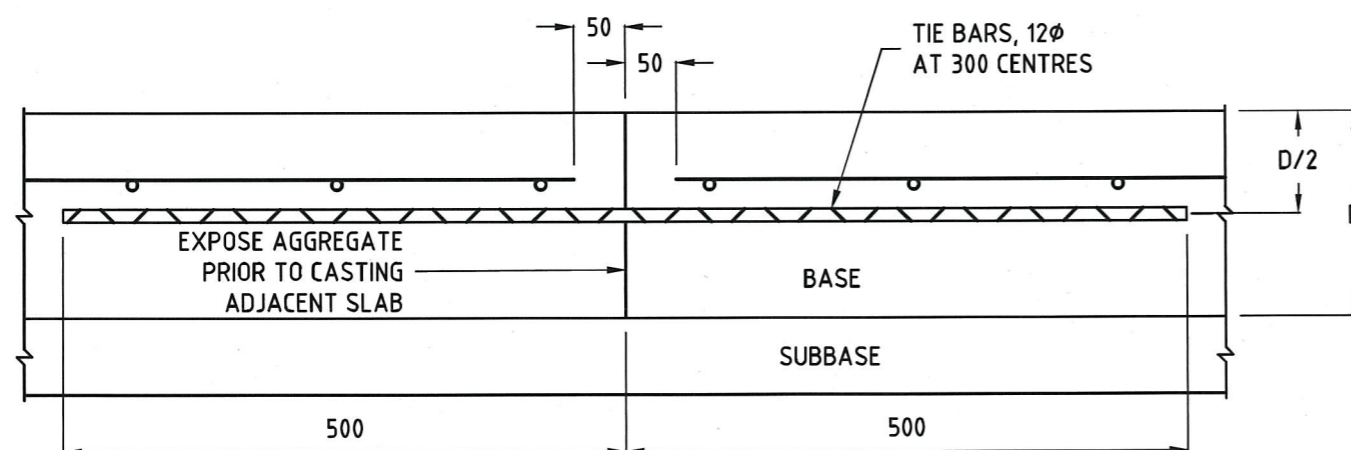

TIED CONSTRUCTION JOINT - NOT AT A CONTRACTION JOINT

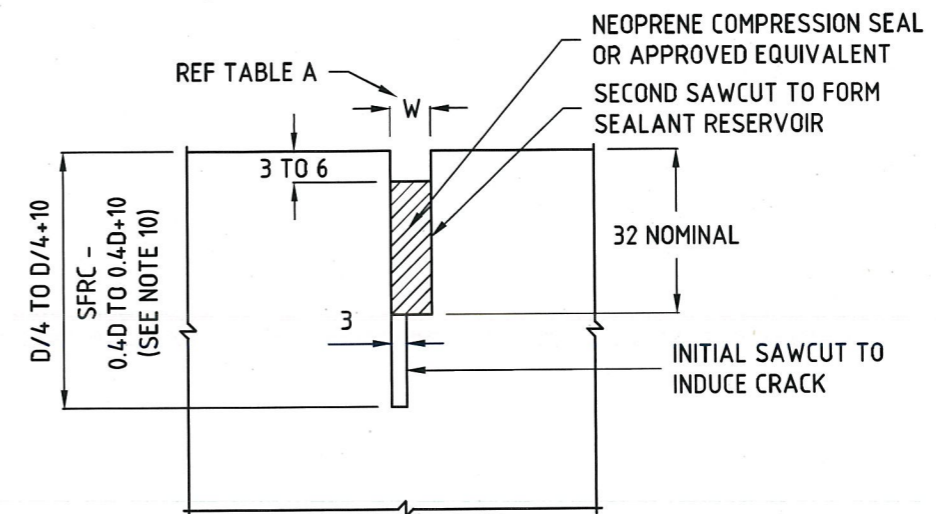

DETAIL A

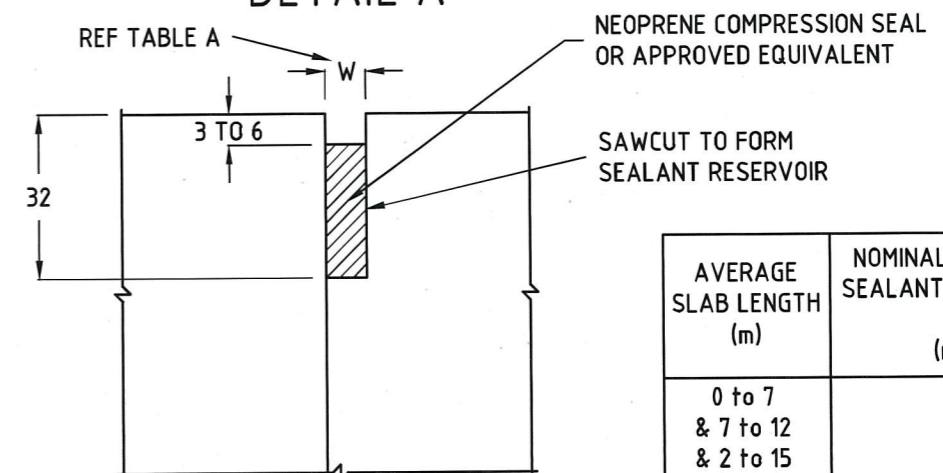

DETAIL B

AVERAGE SLAB LENGTH (m)	NOMINAL WIDTH OF SEALANT RESERVOIR W (mm)
0 to 7	7
& 7 to 12	12
& 2 to 15	15

TABLE A

NOTES

1. DOWEL BAR DIAMETER, LENGTH AND SPACING SHALL BE AS SPECIFIED IN THE SCHEDULE OF DETAILS.
2. DOWELS SHALL BE:
 - SECURELY POSITIONED PARALLEL TO PAVEMENT CENTRELINE AND FINISHED SURFACE.
 - PART COATED AS SHOWN WITH APPROVED BOND BREAKING MATERIAL.
3. TIE BARS SHALL BE SECURELY POSITIONED PARALLEL TO PAVEMENT CENTRELINE AND FINISHED SURFACE.
4. STEEL FABRIC SHALL BE LOCATED IN THE TOP THIRD OF THE BASE AND SHALL HAVE A MINIMUM COVER OF STEEL FABRIC.
5. SUBBASE AND BASE TRANSVERSE JOINTS SHALL BE OFFSET BY A MINIMUM OF 500mm.
6. TIED CONSTRUCTION JOINTS SHALL BE LOCATED IN THE MIDDLE THIRD OF THE SLAB LENGTH AND AT LEAST 1.5m FROM TRANSVERSE CONTRACTION JOINTS.
7. DOWEL CAP MAY BE OMITTED FOR SHORT SLAB (<5m) CONTRACTION JOINTS.
8. SFRC IS STEEL FIBRE REINFORCED CONCRETE.

CITY OF GLEN EIRA

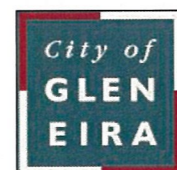

Corner Glen Eira and Hawthorn Roads
PO Box 42
Caulfield South Vic 3162
Phone 9524 3333
Fax 9524 3424
E-Mail mail@gleneira.vic.gov.au
Web www.gleneira.vic.gov.au

	Initials	Date	CAD Reference
Designed	CAP WORKS	AUG 2009	STD-406_CP-JR-TRANS
Drawn	CAP WORKS	AUG 2009	Reference
Checked			VicRoads SD-5311B
Approved			Version
			Date
			16.01.12.
	Dir. Assets & Facilities	Date	

**JOINTED REINFORCED CONCRETE PAVEMENT
TRANSVERSE JOINT DETAIL**

SCALE:	AS SHOWN	DRG. NO.	STD-406	SHEET	1 OF 1
--------	----------	----------	---------	-------	--------