

GlenEira  
City Council  
gallery

Exhibitions  
and public programs  
January–July 2019

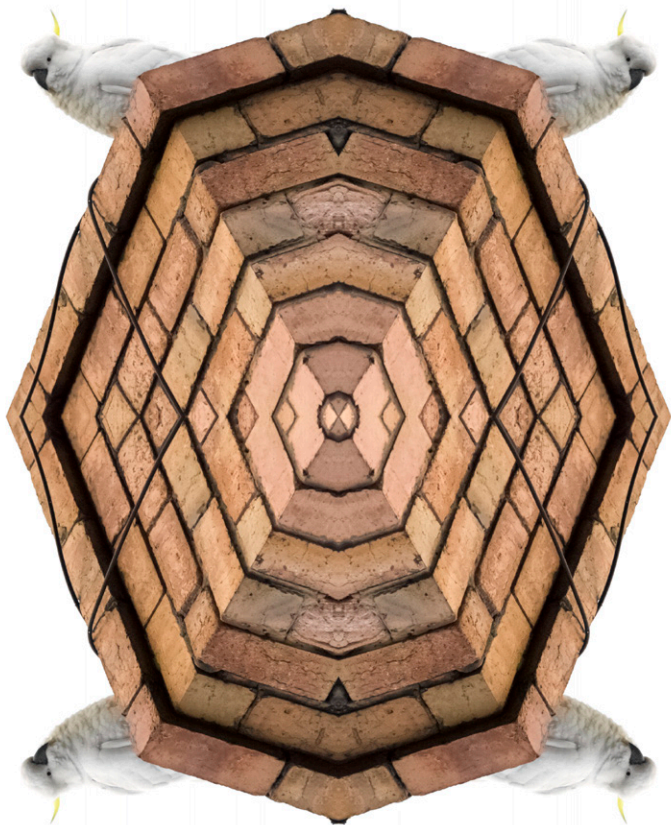

GLEN EIRA  
CITY COUNCIL





## Exhibition dates

**22 January–10 February**

### *Exploring nature*

Works from public gallery  
collections

**Children's display and  
workshops: 3D paper sculpture**  
Gallery Annexe

**14 February–3 March**

*International Baccalaureate  
Visual Arts Exhibition*

**7–24 March**

*Paper Walls*

**7–24 March**

Melbourne School of Design,  
Faculty of Architecture, Building  
and Planning, The University of  
Melbourne.

*Excavating Modernism*

**28 March–17 April**

Glen Eira Artists Society  
*Time*

**28 March–17 April**

Glen Eira Cheltenham Art Group  
*Making our Mark*

**2 May–28 July**

*Celebrating Culture:  
Contemporary Indigenous art*

---

Front cover image:  
Kent Morris

*Boonwurrung (St Kilda) Sulphur crested Cockatoo* 2017  
Archival print. 120 x 80 cm. Edition of eight  
Courtesy of the artist and Vivien Anderson Gallery  
*Celebrating Culture: Contemporary Indigenous art*

---

Inside front cover image:  
Peter Daverington

*Through the Looking Glass Chamber* 2010  
Oil on canvas. 122 x 91 cm  
Port Phillip City Collection. © Peter Daverington  
Courtesy of the Artist and Arc One Gallery  
*Exploring nature. Works from public gallery collections*



---

Fred Williams  
*Lysterfield Landscape* 1973  
Oil on canvas  
107 x 93 cm  
Glen Eira City Council art collection  
© The Estate of Fred Williams

22 January–10 February

## Exploring nature Works from public gallery collections

This exhibition explores diverse interpretations of the landscape and the natural environment in Australian art, encompassing paintings, photography, drawings, and ceramics. Spanning over 100 years of Australian art, the exhibition will include the work of major Australian artists Fred Williams, Arthur Boyd, Emma Minnie Boyd, Clarice Beckett, Max Meldrum, Brett Whiteley, Ponch Hawkes, Stephen Bush, Peter Daverington, Valerie Sparks and other artists.

The cultural significance of local government art collections is celebrated, through a richly layered selection of historical and recent acquisitions. From the atmospheric seascapes of renowned modernist Clarice Beckett, to majestic fantasy visions of nature by contemporary artist Peter Daverington, the exhibition encourages a rich engagement with the natural world.

Works from Glen Eira City Council's art collection; Port Phillip City Collection; Bayside City Council art and heritage collection; and Town Hall gallery collection will be featured.

**Exploring nature:  
public programs — floor talk and children's workshops >**

## Exploring nature: public programs

### Floor talk: Diane Soumilas — Curator

Friday 8 February at midday

Join Diane Soumilas for an engaging talk about the exhibition theme and the history of Council's art collection.

### Children's display and workshops: 3D paper sculpture

Wednesday 23 January. 10am–midday and 1.30pm–3.30pm

Thursday 24 January. 10am–midday and 1.30pm–3.30pm

Galley Annexe

Come and create 3D paper art and sculptures with facilitator Louise Seymour from Paperlab inspired by the *Exploring nature* exhibition. Children can interpret the landscape and environmental themes in the exhibition to create exciting multilayered art.

Drawing from paper art disciplines such as origami, papercutting, collage and sculpture, children will create colourful and creative pieces to be displayed in the Gallery Annexe during the exhibition.

Come, create and experiment with paper.

For children aged five to 10. Tickets: \$5 per child

Bookings are essential and open from 4 January 2019

To book, visit [www.gleneira.vic.gov.au/gallery](http://www.gleneira.vic.gov.au/gallery)

Children must be accompanied by adults.

Image courtesy of Paperlab





14 February–3 March

## **International Baccalaureate Visual Arts Exhibition**

A diverse and exciting range of artworks from the International Baccalaureate Diploma Programme Visual Arts Course are featured in this exhibition. Selected student's works examined in 2018 will be displayed. The works provide visitors with an understanding of the different approaches and the varied work produced in this unique two year study programme. Contemporary sculpture, photography, painting, textiles, drawing, digital media and printmaking are included in this exhibition.

---

Dini Li

*The Equilibrium of Fortune 2018*

Inkjet prints on cotton fabric, machine and hand embroidery and found blue and white china

Installation 69.8 x 103 x 154.4 cm

Presbyterian Ladies College

7–24 March

## Paper Walls

This exhibition features drawings by renowned artist Pam Hallandal (1929–2018) accompanied by artwork from former colleagues and students, including Rick Amor; John Scurry; Michelle Zuccolo; Greg Creek; Allan Mitelman; and other artists. During the early 1970s, Pam Hallandal established the first full time tertiary level drawing course in Australia and her teaching practice spanned over 40 years. She is best known for her large scale, expressive charcoal drawings depicting the human condition.

### Artist talks and panel discussion

#### Friday 8 March, midday

Join artist Michelle Caithness for an engaging discussion about her drawing practice.

#### Sunday 24 March, 2pm

A panel discussion around the practice of drawing.

#### Sunday 17 March, 2pm

Join artists Greg Creek and Sarah Tomasetti for an engaging discussion about their practice.

---

Pam Hallandal  
*Self portrait* 2001  
Charcoal on paper  
92 x 72 cm  
Image courtesy of Elizabeth Cross



B'Nai B'Rith Parents Home (built) (detail)  
Inkerman Street, Caulfield  
K. Popper c. 1960s

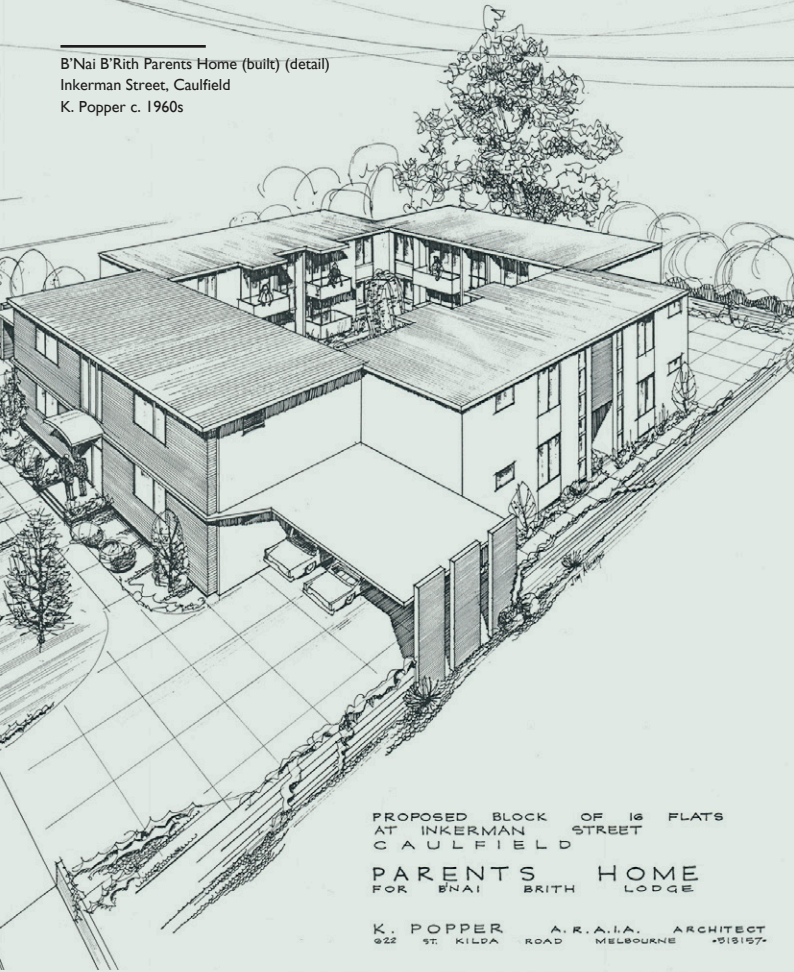

7–24 March

Melbourne School of Design, Faculty of Architecture,  
Building and Planning, The University of Melbourne

## Excavating Modernism

Exploring the deeply embedded cultural tropes evident in post-war Modernist architecture in Melbourne, *Excavating Modernism* seeks to reflect, understand and explore the significant contribution of émigré architects such as Ernest Fooks, Kurt Popper, Herbert Tisher, and Mordechai Benshemesh, amongst others. These architects contributed to the socio-cultural landscape and Melbourne's development at the time, particularly in the south-eastern suburbs. Developed by masters student's at Melbourne School of Design, The University of Melbourne, this exhibition explores these notions through ephemera, artefacts, historical photographs, texts, and film responses.

### Floor talks

#### Friday 15 March at midday

Join masters students from Melbourne School of Design, The University of Melbourne for a discussion about the development of this exhibition and post-war modernist architecture in Melbourne.

#### Friday 22 March at midday

Melbourne School of Design Director Professor Alan Pert will present a floor talk addressing post-war modernist architecture in Caulfield.

28 March–17 April

Glen Eira Artists Society  
**Time**



*Time* is Glen Eira Artists Society's sixth major exhibition. Artists present their interpretation about time using diverse media and styles. Members boldly share their original creations for your enjoyment, with artwork translated into paintings, drawings, sculpture, and mixed media.

---

Emily Levin  
*Quiet Time* 2018 (detail)  
Oil on canvas  
62 x 90 cm

28 March–17 April

Glen Eira Cheltenham Art Group  
**Making our Mark**

This exhibition celebrates the creativity of the Glen Eira Cheltenham Art Group (GECAG) as its members make their mark in the artistic community. Since its inception in 1963, GECAG has successfully nurtured emerging and established local artists through the tutelage and guidance of highly regarded professional artists. This year's exhibition acknowledges and commends this achievement. It features a diverse selection of current works that encompass both traditional and contemporary works in a variety of media.



---

Jennifer Ayre  
*High-rise Guitar* 2017  
Pastel on paper  
42 x 35 cm





2 May–28 July

## **Celebrating Culture: Contemporary Indigenous art**

Works by contemporary Indigenous artists are featured in this exhibition which examines themes of identity, colonisation, personal history, community and the diversity and richness of a significant cultural heritage. Contemporary Indigenous experiences and cultural practices are investigated through a compelling selection of paintings, photography, drawings, mixed-media, video and installations by Brook Andrew, Tony Albert, Michael Cook, Hayley Millar-Baker, Kent Morris, Vincent Namatjira, Wayne Quilliam and James Tylor on loan from public art museum collections, private collections and private galleries.

Curator: Diane Soumilas

Programmed in association with *National Reconciliation Week*, the *2019 Glen Eira Storytelling Festival* and *NAIDOC Week*.



***Celebrating Culture:  
Contemporary Indigenous art  
public programs — floor talks >***

---

Hayley Millar-Baker

*Even if the race is fated to disappear 7 (Peeneeyt Meerreng/Before, Now, Tomorrow) 2017*

Inkjet on cotton rag. Edition of seven

150 x 80 cm

Courtesy of the artist and Vivien Anderson Gallery

## Celebrating Culture: Contemporary Indigenous art — public programs

### Artist's floor talks

#### Hayley Millar-Baker and Kent Morris

Friday 28 June at midday

Join artists Hayley Millar-Baker and Kent Morris for an engaging discussion about their creative practice and the works in the exhibition.

#### Wayne Quilliam

Friday 5 July at midday

Join leading Indigenous photographer, cultural advisor and Adjunct Professor, Design and Social Context, Media and Communication, RMIT University Wayne Quilliam for a discussion about indigenous storytelling and his creative practice.



---

James Tylor  
*Un-resettling (Canoe Tree)* 2017  
From the series *Un-resettling (Huntings)*  
Hand coloured photograph  
Edition of five, 50 x 50 cm  
Courtesy of the artist and Vivien Anderson Gallery

## Upcoming exhibitions

**1–18 August**

24th Annual B'nai B'rith  
Victoria

*Jewish Youth Art Competition*

**22 August–8 September**

Twenty Melbourne Painters  
Society

**22 August–8 September**

Glen Eira Artists Society  
*Portraits*  
Gallery Annexe

**12–29 September**

Phil Kreveld  
*A landscape of memories*

**12–29 September**

Robyn Cottew  
*Icons of Japan*

**3–27 October**

Glen Eira City Council  
Youth Services  
*2019 Youth Art Exhibition*

**2 November–15 December**

Arthur Merric Boyd (AMB) Pottery  
Murrumbeena

---

John Perceval, Arthur Merric Boyd (AMB) Pottery  
Coffee pot c.1950  
painted and glazed stoneware  
28 x 27 x 22 cm  
Heide Museum of Modern Art, Melbourne  
Gift of Barbara Blackman AO 2014  
© The Estate of John Perceval/Copyright Agency  
2018



## History of the Gallery

Since opening in 1975, Glen Eira City Council's Gallery has established a prominent profile within the public gallery sector in Melbourne. Located on the ground floor of the historic Glen Eira Town Hall, access to the Gallery is gained through the majestic classically styled portico on the corner of Glen Eira and Hawthorn Roads, Caulfield.

Through the exhibitions, the regular rotation of Council's permanent art collection in public areas of Town Hall, and the production of curated survey and thematic exhibitions featuring major contemporary Melbourne artists, the Gallery plays an important role in contributing to a rich cultural life for the residents of Glen Eira and the wider community.

## Gallery hire

The Gallery is a popular hire space for local artists and other groups. The floor-to-ceiling panels can be moved to divide the Gallery into half of the full gallery space. The Annexe space is also available for use by community groups at no cost. Online applications are accepted until June 2019 for the 2020 Gallery program via Council's website. Visit [www.gleneira.vic.gov.au/gallery-hire](http://www.gleneira.vic.gov.au/gallery-hire) For further information, contact 9524 3333 or email [arts@gleneira.vic.gov.au](mailto:arts@gleneira.vic.gov.au)

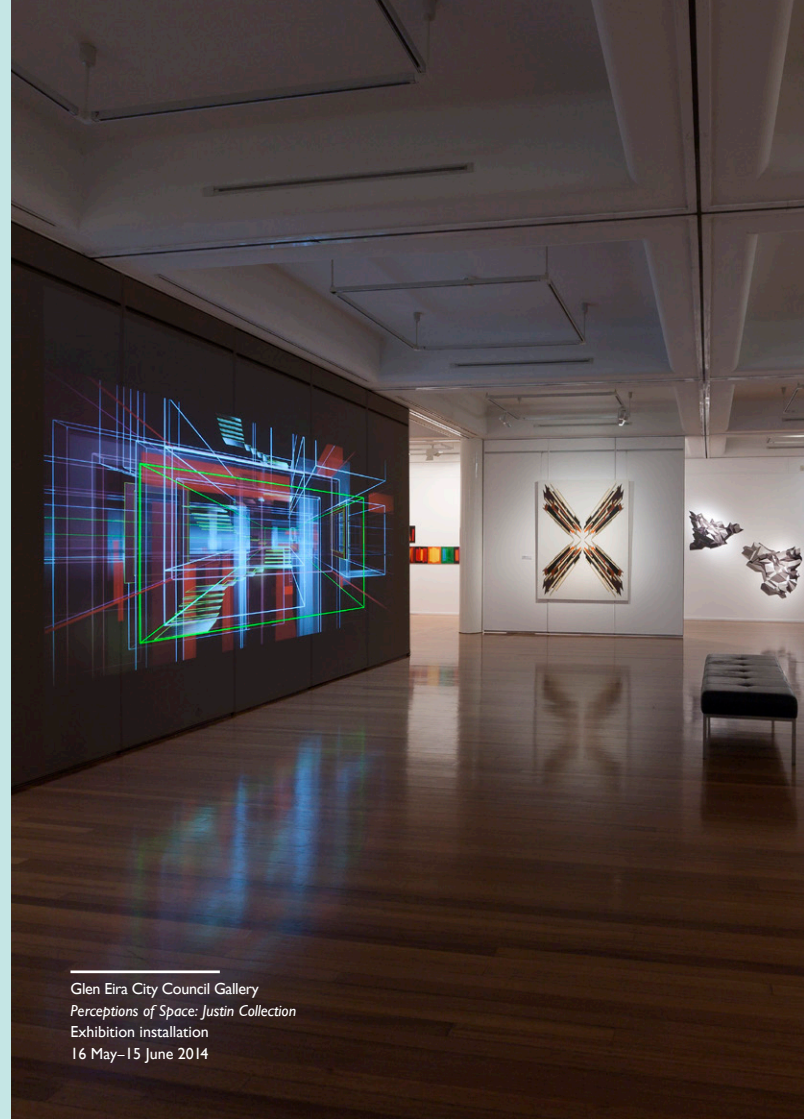

Glen Eira City Council Gallery  
*Perceptions of Space: Justin Collection*  
Exhibition installation  
16 May–15 June 2014

# Glen Eira City Council gallery

Corner Glen Eira and Hawthorn Roads  
Caulfield 3162  
9524 3333

Enter via Glen Eira Road

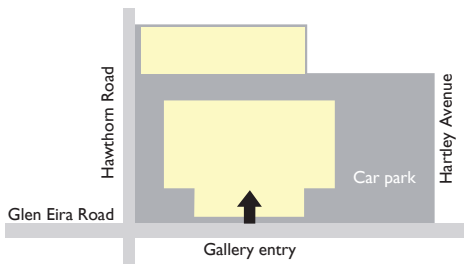

Admission is free.

Gallery hours:

Monday to Friday, 10am–5pm.

Weekends, 1pm–5pm.

Closed public holidays.

The Gallery is wheelchair accessible.

There is also accessible parking in the car park.

Public transport: tram route 64, bus route 623.

[www.gleneira.vic.gov.au](http://www.gleneira.vic.gov.au)

[arts@gleneira.vic.gov.au](mailto:arts@gleneira.vic.gov.au)



GLEN EIRA  
CITY COUNCIL

Bentleigh  
Bentleigh East  
Brighton East  
Carnegie  
Caulfield  
Elsternwick  
Gardenvale  
Glen Huntly  
McKinnon  
Murrumbeena  
Ormond  
St Kilda East



[/gleneiraarts](https://www.facebook.com/gleneiraarts)



[@cityofgleneira](https://www.instagram.com/cityofgleneira)