

Landscape Plan

What is a landscape plan?

A landscape plan is a plan which details the proposed landscaping of a site and must be submitted and approved prior to the commencement of buildings and works.

Before preparing a landscape plan you must refer to the planning permit to ensure that any specific landscaping conditions can be incorporated into the plan. Council strongly recommends that a qualified landscape designer or landscape architect be employed to prepare landscape plans.

What does a landscape plan need to detail?

The Landscape Plan must show the location of all proposed vegetation and must incorporate the following:

- The site boundaries and building envelope as detailed on the endorsed development plans including;
 - Location of crossovers, power poles, nature strips and any street trees;
 - Location, height and construction materials of all fences;
 - Location, height and construction materials of retaining walls and other proposed structures (for example, barbecues, water features, etc); and
 - Construction materials and finishes of all driveways, paths and other hard surfaces;
- Buildings and trees (including botanical names) on neighbouring properties within 3 metres of the boundary;
- A survey, including full botanical names, of all existing vegetation on the subject site to be retained and removed;
- A complete plant schedule of proposed vegetation including full botanical names; common names; pot sizes at maturity; height and width of plants at maturity and total quantities of each plant;
- Clear delineation of garden beds, lawn and paved areas;
- Type of garden bed edge;
- Notes regarding fertiliser, mulch, irrigation and any specific maintenance requirements.

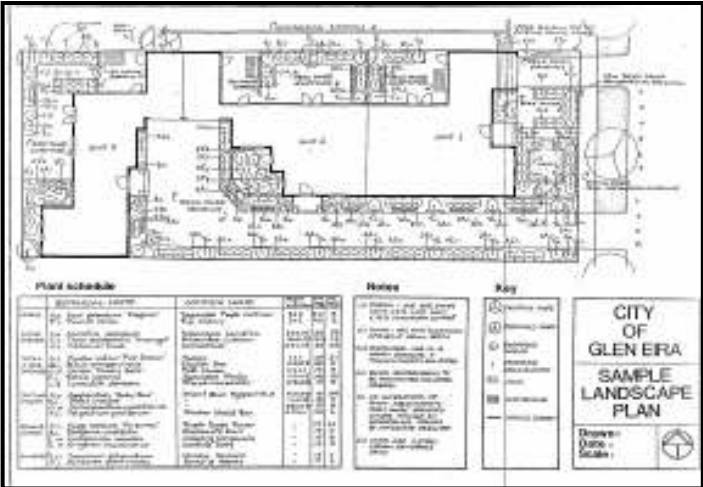

Please note: These requirements may vary depending on the extent of the proposed development. This list of information to be provided is not exhaustive and is intended as a guide for applicants only. Additional items may be required to enable a proper consideration of an application. Council reserves the right to request additional information pursuant to Section 54(1) of the Planning and Environment Act (1987).

Contact

Glen Eira City Council
Corner Glen Eira and Hawthorn Roads, Caulfield

Telephone: 9524 3333
Fax: 9523 0339
Website: www.gleneira.vic.gov.au
Email: mail@gleneira.vic.gov.au

Office hours

Monday, Wednesday, Thursday and Friday 8.30am–5pm
Tuesday 8.30–7.15pm

The material contained in this document is for information purposes only and does not constitute advice by Council. Readers are responsible for making their own assessment of the information provided and are advised to verify all relevant statements and information and obtain independent advice before acting in connection with it. While all reasonable efforts have been made to ensure that the information is accurate, Council will not accept liability for any loss or damage that may be incurred by any person acting in reliance upon the information or any part of it.

